



SP 408 SERIES

"All stainless steel" Bourdon tube pressure gauges with compact element

- ◆ watertight casing, dry or liquid filled execution;
- ◆ NS - 100 - 150;
- ◆ ranges included between -1 and 1000 bar.



made in
ITALY



PED 2014/68/EU
ATEX 2014/34/EU



TECHNICAL FEATURES

- **Nominal sizes**
 - 100, 150.
- **Casing**
 - case and ring in AISI 304 stainless steel with bayonet bezel (execution B).
- **Protection degree (according to EN 60529)**
 - IP 55 for execution D (dry);
 - IP 67 for execution F (liquid filled) and for execution P (fillable).
- **Window**
 - tempered glass for NS 100 and 150;
 - laminated safety glass (option V17).
- **Blow-out device**
 - blow out plug.
- **Filling liquid**
 - glycerine (standard);
 - silicone fluid (on request - option V64).
- **Pressure connection (according to EN 837-1)**
 - Gas (BSP) or NPT thread as F dimension shown in SP tables, otherwise only on request:
 - AISI 316L stainless steel (execution 2).
- **Pressure element**
 - AISI 316L stainless steel (execution 2).
- **Welding**
 - TIG.
- **Movement**
 - stainless steel.
- **Ranges (according to EN 837-1)**
 - o **Maximum value:**
 - 1000 bar.
 - o **Scale ranges for pressure values between -1 and 1000 bar:**
 - pressure gauges: see table C1 at page P04;
 - vacuum gauges and compound gauges: see table C1 at page P04;
 - other graduations not normalized for single or double range (on request).
- o **Unit of pressure:**
 - bar, kPa, MPa, kg/cm² and psi for single or double range.
- o **Scale angle:**
 - 270 °.
- **Working pressure (referred to full scale deflection)**
 - steady from 1/10 to 3/4;
 - fluctuating from 1/10 to 2/3;
 - pulsating from 1/10 to 1/2.
- **Over-pressure (occasionally allowed)**
 - 130% of full scale value.
- **Pointer**
 - aluminium with micrometer adjustment.
- **Dial**
 - white aluminium with black figures (for dial modifications see available options);
 - stop pin on "0".
- **Accuracy (according to EN 837-1)**
 - class 1 ($\pm 1\%$ of full scale deflection).
- **Ambient temperature**
 - $-40 \div +60$ °C dry execution;
 - $-20 \div +60$ °C glycerine filled execution;
 - $-40 \div +60$ °C silicone fluid filled execution.
- **Thermal drift**
 - out of optimum ambient temperature values included within $+15 \div +25$ °C, the thermal drift affects the instruments accuracy of 0,3% every 10 °C.
- **Operating temperature**
 - $-40 \div +250$ °C dry execution;
 - $-20 \div +100$ °C glycerine filled execution;
 - $-40 \div +120$ °C silicone fluid filled execution.

APPLICATIONS

- **Accessories (see AM series)**
- **Diaphragm seal (see FP series)**

OPTIONS

- **Maximum pointer**
to indicate the maximum pressure reached:
 - zero setting on the window (only NS 100 and 150).
(identification V11)
 - **Red pointer on the dial**
only NS 100 and 150. (identification V14)
 - **Window**
different from standard (only NS 63, 100 and 150):
 - methacrylate;
(identification V16)
 - laminated safety glass.
(identification V17)
 - **Restrictor**
applicable to pressure connection to reduce the process fluid entry speed.
(identification V26)
 - **Degreasing for oxygen service**
(identification V31)
 - **Process connection**
not standard.
(identification V42)
 - **Changes to the dial**
 - serial number;
(identification V50)
- specific dial;
(identification V51)
 - red mark;
(identification V52)
 - writings;
(identification V53)
 - TAG number;
(identification V54)
 - dial without logo;
(identification V56)
 - double logo (Fantinelli + customer);
(identification V57)
 - customer's logo.
(identification V58)
 - **AISI 316 stainless steel case and ring**
as alternative to AISI 304 stainless steel for NS 100 and 150 (for model SP 208 only).
(identification V61)
 - **Silicone fluid**
as alternative to glycerine.
(identification V64)
 - **Tropicalization**
requires AISI 316 stainless steel case and ring.
(identification V67)
 - **Metal tag plate**
AISI 316 stainless steel for tag number.
(identification V82)

DOCUMENTATION

- **Fantinelli calibration certificate**
 - class 1.
(identification V92)
- **Complementary documents**
 - o certificate of compliance with the order EN 10204 -2.2.
 - o Technical documentation including:
 - drawings and technical informations;
 - installation and maintenance instructions.
 - o inspection and test certificate EN 10204-3.1.
 - o material certificate.
 - o PED declaration.
 - o ATEX declaration (II 2 G/D).

TECHNICAL INFORMATIONS

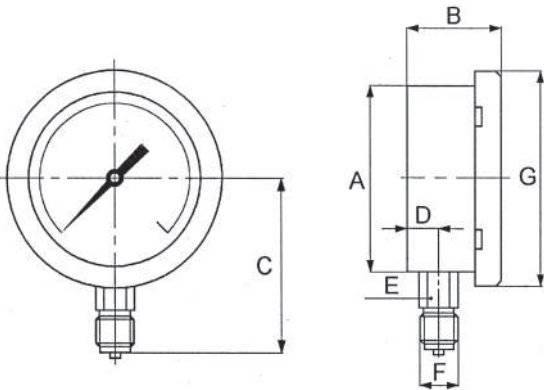

Table SP 408

| DN | A | B | C | D | E | F | G | H | I | L | M | N | Ø fori 120° | PESO ~ kg es. D es. F |
|-----|-----|----|-----|----|----|-----|-----|---|---|---|---|---|-------------|-----------------------|
| 100 | 100 | 49 | 90 | 15 | 22 | 1/2 | 112 | | | | | | | 0,57 0,91 |
| 150 | 151 | 49 | 114 | 15 | 22 | 1/2 | 166 | | | | | | | 0,92 1,79 |

Pressure gauge with bottom connection for local mounting.

note: informations shown in this series may be changed at any time without prior notice.